

EN Cordless pressure washer

MC11229PRW
5063022665546
5063022665676

MCB1484PRW
5063022675972
(bare tool)

TTB1485PRW
5063022675965
(bare tool)

TTI1230PRW
5063022665591
5063022665515

EN IMPORTANT - These instructions are for your safety. Please read through them thoroughly prior to handling the product and retain them for future reference.



V10925_5063022665546_MAND4_2425_RP0539

EN Parts

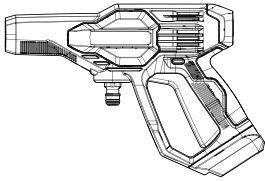

01. x1

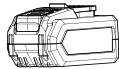

02. x1



03. x1

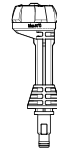

04. x1

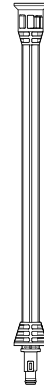

05. x1

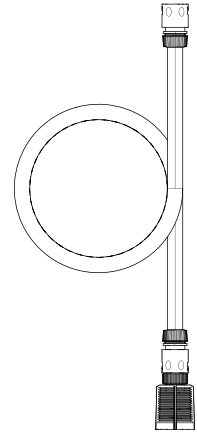

06. x1

EN You will need

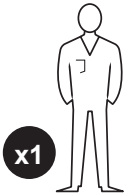

EN Contents

EN	
Product description	3
Safety	4
Technical specifications	9
Preparation	10
Functions & settings	15
Use	15
Care and maintenance	16
Guarantee	20

EN Product description

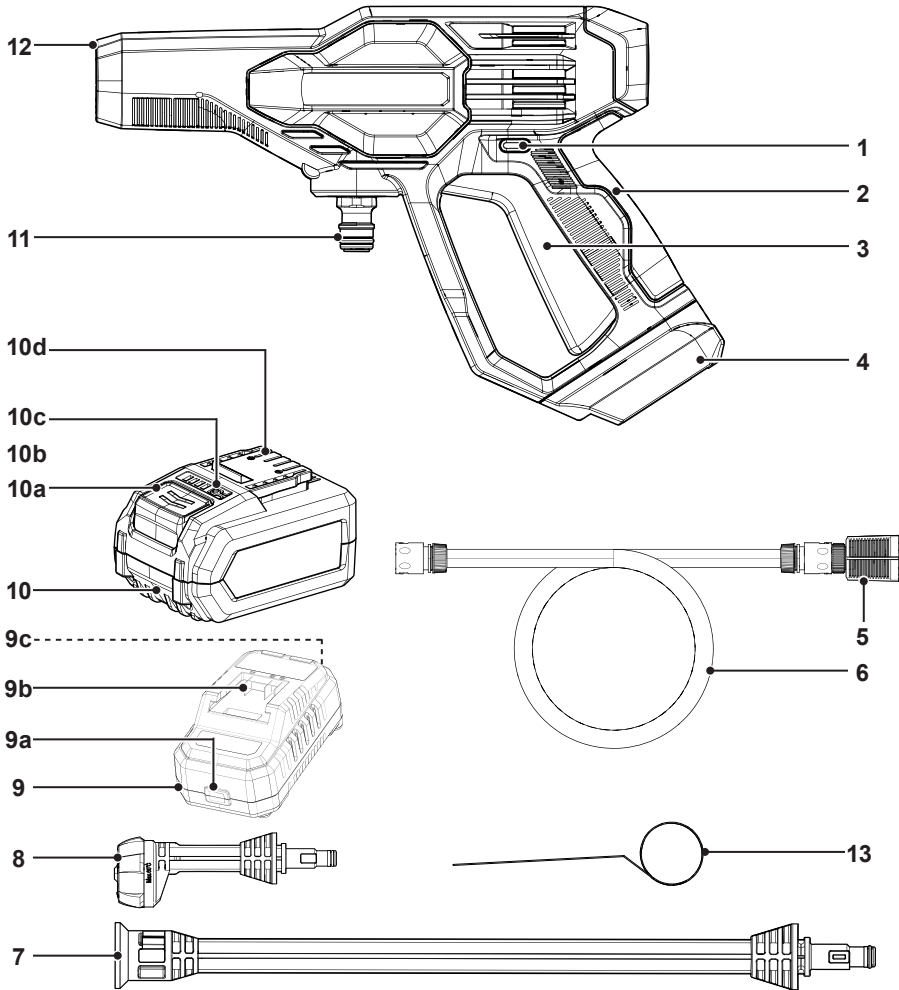

EN 1. Safety lock

2. Handle

3. Trigger

4. Battery slot

5. Filter with valve opener

6. Suction hose

7. Spray wand

8. Five-in-one nozzle

9. Battery charger

a) LED indicator

b) Battery pack intake

c) Mains cord with mains plug

10. Battery pack

a) Release button

b) Battery capacity indicator

c) Battery capacity button

d) Charging contacts

11. Water inlet

12. Water outlet

13. Needle



**IMPORTANT
READ CAREFULLY BEFORE USE.
KEEP FOR FUTURE REFERENCE.**

Safety warnings



WARNING! ONLY USE THE BATTERY PACK (MODEL: MBAT18-5 / TTI803BAT) PROVIDED WITH THIS APPLIANCE.

- This appliance can be used by persons with reduced physical, sensory or mental capabilities or lack of experience and knowledge if they have been given supervision or instruction concerning use of the appliance in a safe way and understand the hazards involved. Children shall not play with the appliance.
- Non-rechargeable batteries are not to be recharged.
- Rechargeable batteries are to be removed from the appliance before being charged.
- Batteries are to be inserted with the correct polarity.
- Exhausted batteries are to be removed from the appliance and safely disposed of.
- This is a battery-operated appliance. The battery pack is being charged outside the appliance.
- Do not direct the spray jet towards equipment that contains electrical components.
- Remove the battery pack from the appliance after use and before user maintenance.
- The appliance is not to be used if it has been dropped, if there are visible signs of damage or if it is leaking. The new hose-sets supplied with the appliance are to be used and that old hose-sets should not be reused when connected to the water mains.

Additional safety instructions



WARNING! ONLY USE THE APPLIANCE WITH CLEAR WATER AT A TEMPERATURE BELOW +60 °C.

- Keep the appliance out of reach of children while it is energized or cooling down.
- Never leave the appliance running when unattended.
- Pay attention to other persons in the vicinity when working with the appliance.
- Do not operate the product when fatigued or under the influence of alcohol or drugs.
- Do not use the appliance with flammable or toxic liquids. Use of the appliance in a potentially inflammable or explosive atmosphere is forbidden.
- According to applicable regulations, the appliance must never be used on the drinking water net without a system separator. Ensure that the connection of your building water installation on which the appliance is operated is equipped with a system separator pursuant. Water that has flown through backflow preventers is considered to be non-potable.
- Use only original spare parts from the manufacturer or recommended by the manufacturer.
- Discharge residual pressure by the use of the trigger before disconnecting the suction hose from the appliance.
- Only switch on the appliance when water is present in the water reservoir. There is a risk of appliance damage due to dry running.
- Avoid spraying into the wind or any water source to prevent contamination and ensure safe application.
- Never use the appliance in a room where there is a danger of explosion or in the vicinity of flammable liquids or gases.
- Do not immerse the appliance in water or other liquids. Do not place the appliance where it can fall or be pulled into a tub or sink.
- Do not operate the appliance when the ambient temperature is below 0 °C. Water will freeze inside the appliance and damage it.
- Do not under any circumstances modify the appliance. Modifications can result in serious personal injury.

- Never point or aim the nozzle to the animals, pets, people and at yourself.
- Do not lift the appliance by the suction hose or spray wand.
- Always check the hose. A damaged or loose hose connection can result in unintended pressure exposed to the personal injury.

Safety warnings for the battery pack

- **Recharge only with the charger specified by the manufacturer.** A charger that is suitable for one type of battery pack may create a risk of fire when used with another battery pack.
- **Use the appliance only with specifically designated battery packs.** Use of any other battery packs may create a risk of injury and fire.
- **When battery pack is not in use, keep it away from other metal objects, like paper clips, coins, keys, nails, screws or other small metal objects, that can make a connection from one terminal to another.** Shorting the battery terminals together may cause burns or a fire.
- **Under abusive conditions, liquid may be ejected from the battery; avoid contact. If contact accidentally occurs, flush with water. If liquid contacts eyes, additionally seek medical help.** Liquid ejected from the battery may cause irritation or burns.
- **Do not use a battery pack or appliance that is damaged or modified.** Damaged or modified batteries may exhibit unpredictable behaviour resulting in fire, explosion or risk of injury.
- **Do not expose a battery pack or appliance to fire or excessive temperature.** Exposure to fire or temperature above +130 °C may cause explosion.
- **Follow all charging instructions and do not charge the battery pack or appliance outside the temperature range specified in the instructions.** Charging improperly or at temperatures outside the specified range may damage the battery and increase the risk of fire.

Additional safety warnings for the battery pack

- The battery pack needs to be charged before use. Always refer to the charger's instruction and charge it properly.
- Remove the battery pack from the appliance when not in use or if the appliance is to be stored unused for a long period.
- Do not maintain the battery pack on the charger when not in use.
- After extended periods of storage, it may be necessary to charge and discharge the battery pack several times to obtain the maximum performance.
- Longer life and better performance can be obtained if the battery is charged when the air temperature is between 0 °C and +45 °C. Do not charge the battery in air temperature below 0 °C or above +45 °C. This is important as it can prevent serious damage to the battery.
- Do not charge battery in a damp or wet location. Following this rule will reduce the risk of electric shock.
- Do not disassemble the battery and avoid mechanical damage to the battery. Risk of short circuit and fumes may be emitted. Ensure fresh air and seek medical assistance in the event of discomfort.
- When disposing of the battery pack, keep the battery pack of different electrochemical systems separate from each other.
- Do not connect the positive terminal and negative terminal of the battery to each other with any metal object (such as wire).
- Do not carry or store battery together with necklaces, hairpins or other metal objects.
- Do not pierce the battery with nails, strike the battery with a hammer, step on the battery or otherwise subject it to strong impacts or shocks.
- Do not solder directly onto the battery.
- Do not expose the battery to water or salt water, or allow the battery to get wet.
- Do not disassemble or modify the battery.
- Do not place the battery in or near fire, on stoves or on other high temperature locations. Do not place the battery in direct sunlight, or use or store the battery inside cars in hot weather.
- Do not place the battery in microwave ovens, high pressure containers or on induction cookware.

Symbols

On the appliance, the rating label and within these instructions you will find among others the following symbols and abbreviations. Familiarise yourself with them to reduce hazards like personal injuries and damage to property.

V	Volt	Hz	Hertz
W	Watt	A	Ampere
°C	Degree Celsius	cm	Centimetre
h	Hour	min	Minute
kg	Kilogram	L	Litre
yyWxx	Manufacturing date code; year of manufacturing (20yy) and week of manufacturing (Wxx).		



CAUTION!
WARNING!
DANGER!



Note / Remark.



Read operator's manual.



Do not connect the appliance directly to the public drinking water network.



Protection class II (battery charger only).



This symbol is known as the 'Crossed-out Wheelie Bin Symbol'. When this symbol is marked on a product or battery, it means that it should not be disposed of with your general household waste. Some chemicals contained within electrical/electronic products or batteries can be harmful to health and the environment. Only dispose of electrical/ electronic/battery items in separate collection schemes, which cater for the recovery and recycling of materials contained within. Your co-operation is vital to ensure the success of these schemes and for the protection of the environment.



Crossed out dust bin. Batteries and battery packs should not be disposed of with household waste. Please recycle where facilities exist. Check with your Local Authority or local store for recycling advice. Do not dispose of battery packs in rivers or immerse in water.



The appliance complies with the applicable European directives and an evaluation method of conformity for these directives was done.



The appliance complies with the conformity requirements of the applicable UK regulations.

EN Technical Specifications

Appliance

> Rated voltage	:	18 V $\overline{\text{---}}$
> Rated power	:	250 W
> Rated pressure	:	22 bar
> Maximum inlet pressure	:	0.5 MPa
> Maximum water temperature	:	+60 °C
> Maximum flow	:	2.1 L/min
> Hose length	:	6 m
> Operating time with a full battery	:	approx. 45 min
> Weight with battery and charger	:	approx. 3.39 kg
> Weight without battery and charger	:	approx. 2.29 kg
> Dimensions	:	approx. 858 x 80 x 270 mm

Battery charger

TTB1276CHR / MCB1277CHR

> Battery type	:	18 V $\overline{\text{---}}$ 5000 mAh Li-ion
> Input voltage	:	220–240 V~
> Input AC frequency	:	50 Hz
> Protection class	:	II (double insulated)
> Output voltage	:	21.4 V $\overline{\text{---}}$
> Charging current	:	4.0 A
> Charging time	:	approx. 80 min
> Rated input power	:	100 W (\pm 10%)
> Operating temperature	:	0 °C to +45 °C
> Storage temperature	:	-20 °C to +50 °C

Rating label explanation

Appliance:

MC11229PRW = Model number

MC = MacAllister Brand

I = 18 V

1229 = Sequential code

PRW = Pressure washer

TTI1230PRW = Model number

TT = Titan Brand

I = 18 V

1230 = Sequential code

PRW = Pressure washer

MCB1484PRW

MC = MacAllister Brand

B = Bare tool

1484 = Sequential code

PRW = Pressure washer

TTB1485PRW

TT = Titan Brand

B = Bare tool

1485 = Sequential code

PRW = Pressure washer

EN Preparation

Unpacking



WARNING! THE APPLIANCE AND THE PACKAGING ARE NOT CHILDREN'S TOYS!

CHILDREN MUST NOT PLAY WITH PLASTIC BAGS, SHEETS AND SMALL PARTS! THERE IS A DANGER OF CHOKING AND SUFFOCATION!



NOTE: Water residue may be present due to the appliance undergoing a water leak test at the factory, and this is normal.

1. Unpack all parts and lay them on a flat, stable surface.
2. Remove all packing materials and shipping devices, if applicable.
3. Make sure the delivery contents are complete and free of any damage. If you find that parts are missing or show damage do not use the appliance but contact your dealer. Using an incomplete or damaged appliance represents a hazard to people and property.
4. Ensure that you have all the accessories and tools needed for assembly and operation.

Attaching/removing the battery pack

1. To attach the battery pack (10) to the appliance, slide the battery pack (10) into the battery slot (4). The charging contacts (10d) are securely fastened when the battery pack (10) audibly clicks into position (Fig. 1).

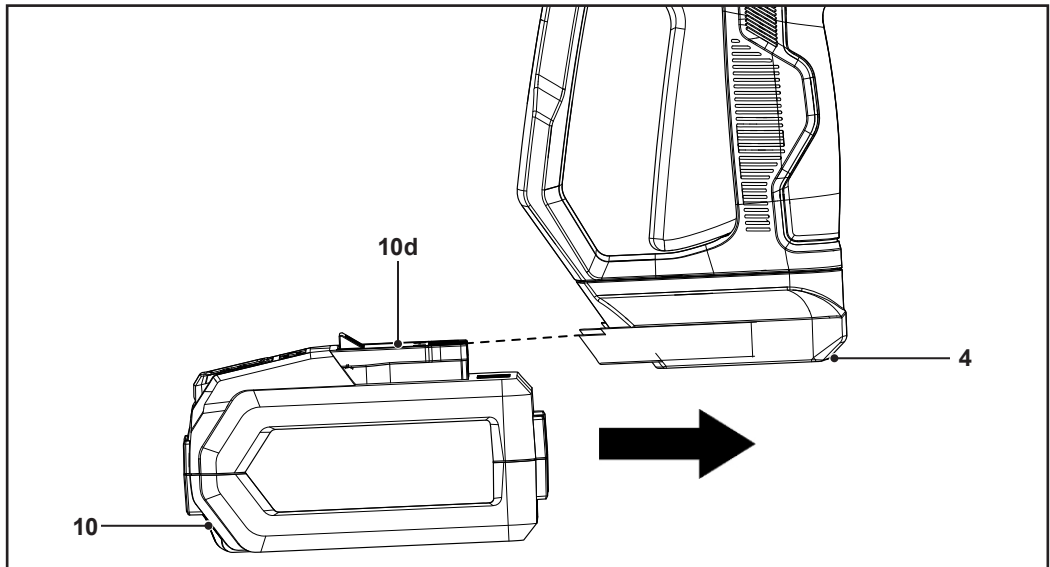

Fig. 1

2. To remove the battery pack (10) from the appliance, press the release button (10a) and pull the battery pack (10) to detach it from the battery slot (4) (Fig. 1).

Charging the battery pack



NOTE: Charge the battery pack (10) fully before first use. The charging cycle takes about 80 minutes.



NOTE: Charge the battery pack (10) when the battery capacity indicator (10b) lights up red (indicating low battery) or flashes red (indicating an empty battery).

1. Connect the mains plug (9c) of the battery charger (9) to a suitable mains outlet. The LED indicator (9a) lights up.
2. Slide the battery pack (10) into the battery charger (9). The charging contacts (10d) have to engage into the battery pack intake (9b) (Fig. 2). The charging cycle begins and the battery capacity indicator (10b) flashes green.
3. Once charging is complete, the battery capacity indicator (10b) becomes green. Remove the battery pack (10) from the battery charger (9).

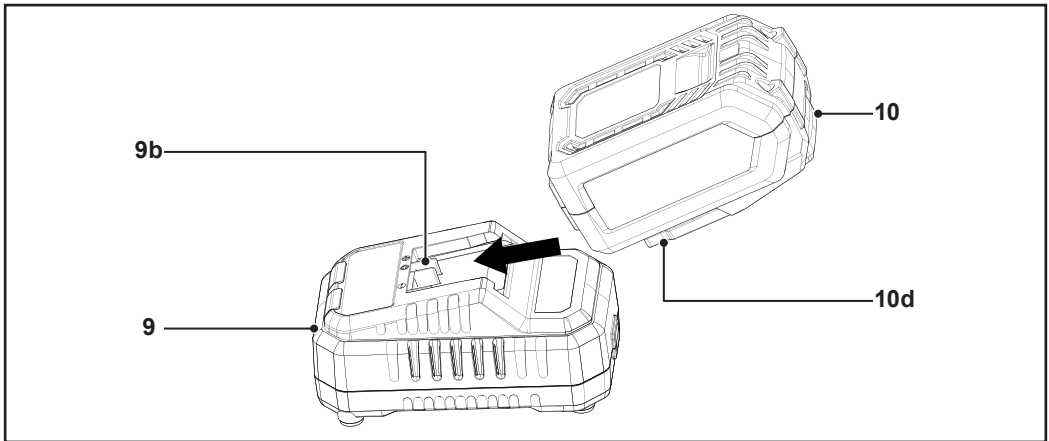







Fig. 2

Checking the battery capacity



NOTE: The battery pack (10) is equipped with the battery capacity indicators (10b) which are used to give an indication of the battery pack's remaining capacity.

Press the battery capacity button (10c) to check the battery capacity (Fig. 3). The battery capacity indicators (10b) light up for approximately 5 seconds:

 Battery capacity	
	76 % – 100 %
	51 % – 75 %
	26 % – 50 %
	5 % – 25 %
	< 5 %

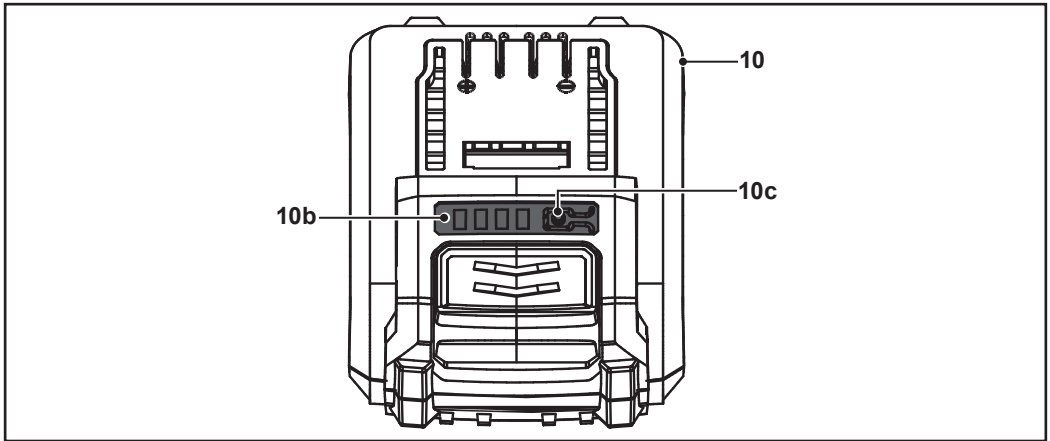

Fig. 3

Installing the attachments



NOTE: The appliance can be used with the following attachments:

- Option 1: Five-in-one nozzle (8)
- Option 2: Five-in-one nozzle (8) with the spray wand (7).

Option 1: Using the five-in-one nozzle

1. Insert the five-in-one nozzle (8) into the water outlet (12) (Fig. 4). The protrusions on the five-in-one nozzle (8) have to fit the recesses on the water outlet (12).
2. Rotate the five-in-one nozzle (8) until it is secured on the appliance.

Option 2: Using the five-in-one nozzle with the spray wand

1. Insert the spray wand (7) into the water outlet (12) (Fig. 4). The protrusions on the spray wand (7) have to fit the recesses on the water outlet (12).
2. Rotate the spray wand (7) until it is secured on the appliance.
3. Insert the five-in-one nozzle (8) into the spray wand (7). The protrusions on the five-in-one nozzle (8) have to fit the recesses on the spray wand (7).
4. Rotate the five-in-one nozzle (8) until it is secured on the spray wand (7).

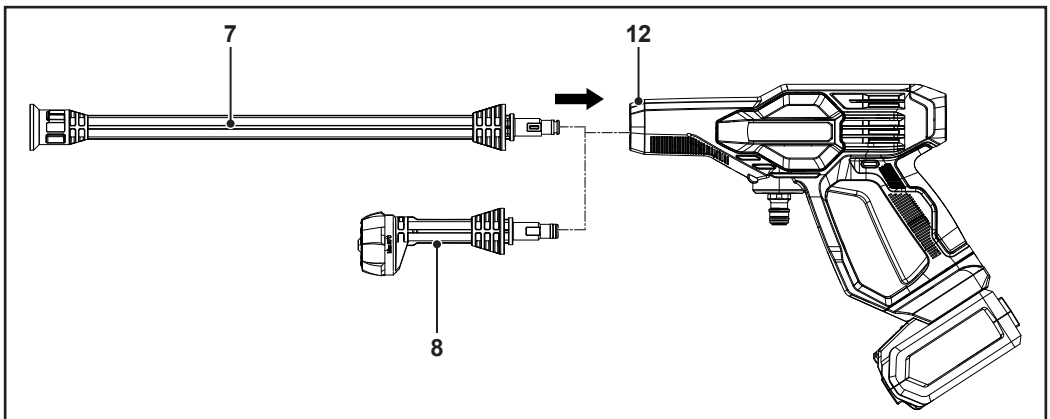

Fig. 4

Connecting the suction hose to the water inlet

i **NOTE:** If the appliance is used for suction from a container, always attach the filter with valve opener (5) to the male coupler of the suction hose (6).

i **NOTE:** This appliance can be used to extract surface water, e.g. from water butts or ponds.

1. Connect the female coupler of the suction hose (6) to the water inlet (11) of the appliance (Fig. 5).
2. Insert the male coupler of the suction hose (6) into a suitable container or connect it to the water supply from mains.

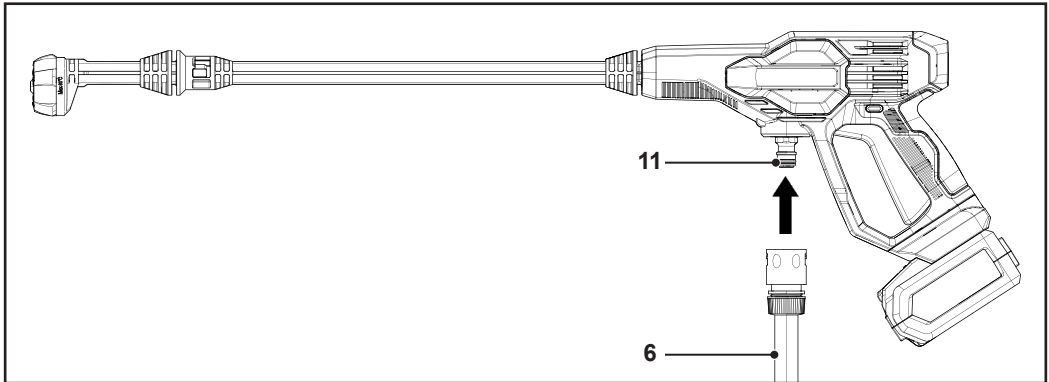

Fig. 5

Water supply with suction hose (self-priming)

The self-priming feature allows the product to draw water from an alternative water source such as a rain water cistern instead of a water supply main.

i **NOTE:** Pay attention to the amount of water in the water source to ensure that there is sufficient supply of water to avoid the pump running dry.

1. Attach one end of the suction hose onto the water inlet adaptor and then keep the other end in the water source. (Fig. 6)
2. Adjust the position of the Filter with valve opener to prevent the filter from being blocked by debris at the bottom of the water source.

The air in the water hose should be pushed through and replaced with the water drawn in from the water source.

During first use, to empty the air in the suction hose. Place the nozzle below waist level (<1.2 m) and set the Five-in-one nozzle at the 0+ position to accelerate the self-priming process. This could take up to 30 s or more depending on the fresh water source.

Press the Safety lock and then press the trigger to switch the product on until the water exits the spray gun continually without lots of bubbles.

In case of no water sprayed out within 60 seconds, inspect all the connections and the water source.

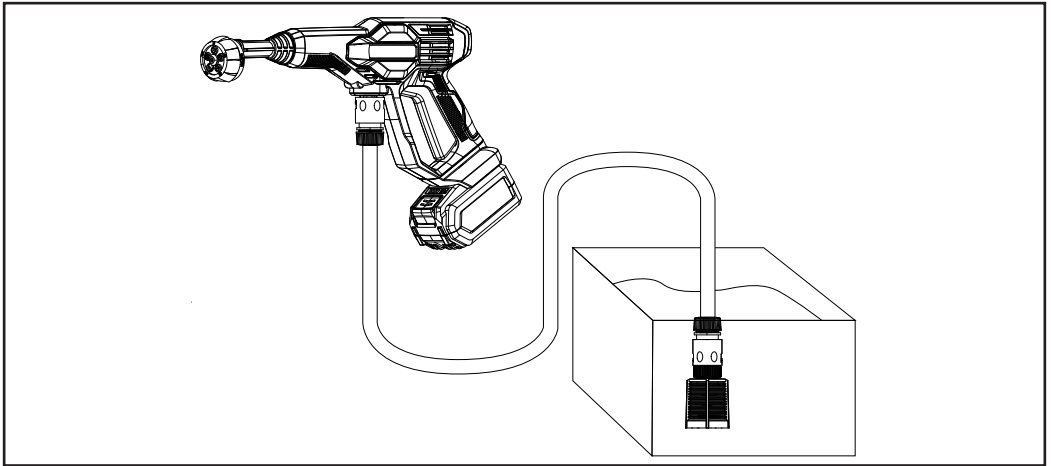

Fig. 6

Water supply with water hose (connect to water tap)



WARNING: THIS PRODUCT IS NOT INTENDED TO BE CONNECTED TO THE POTABLE WATER MAINS.

1. Carefully remove the filter with valve opener (5) from the suction hose (6) (Fig. 7).
2. Attach the suction hose on water inlet and then the other end onto the water supply
3. Open the water supply.

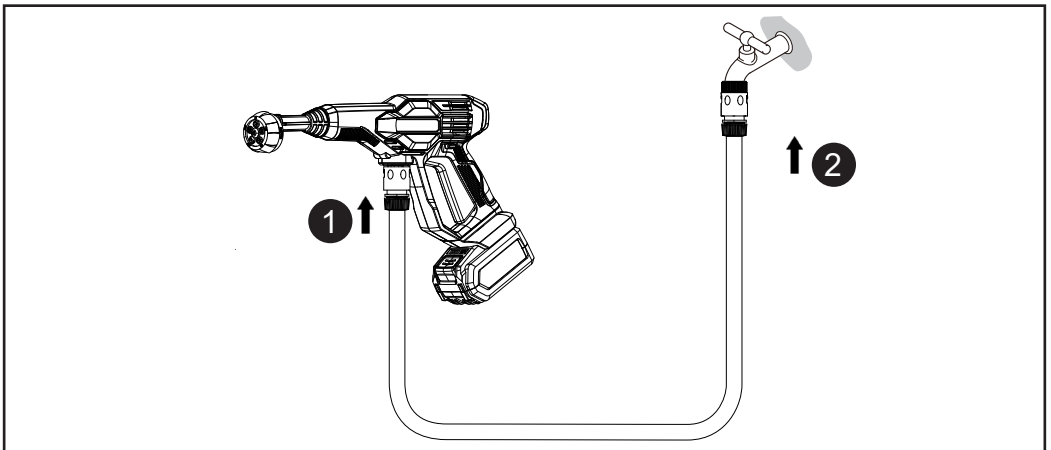

Fig. 7

Removing the suction hose from the water inlet

1. Remove the male coupler of the suction hose (6) from the container or from the water supply.
2. Pull down the female coupler of the suction hose (6). Remove the suction hose (6) from the water inlet (11).

Intended use

This pressure washer MCI1229PRW / TTI1230PRW is designated with rated voltage of 18 V. The appliance is intended for use only with the supplied battery pack (model: MBAT18-5 / TTI803BAT).

The appliance is intended to be used for cleaning vehicles, tools, facade, garden equipment, paving slabs or rain gutters. Do not direct the spray at any electrical equipment to prevent electric shock.

For safety reasons it is essential to read the entire instruction handbook before first operation and to observe all the instructions therein. This appliance is intended for private domestic use only, not for any commercial trade use. It must not be used for any purposes other than those described.

EN Use

Using the appliance



NOTE: Dry running of appliance leads to damage of the pump. If the appliance does not build up pressure within 1 minute, switch the appliance off and proceed in accordance with the instructions in Chapter “Troubleshooting”.



NOTE: Impurities in the water can damage the appliance and the accessories.

1. Hold the handle (2) with both hands.
2. Direct the five-in-one nozzle (8) away from yourself towards the object to be cleaned.
3. Adjust the number at the five-in-one nozzle (8) for the desired selection:

Operating mode	Application
0+	• Ideal for light cleaning of tools and surfaces, and for gentle watering.
0	• Ideal for stains that stick to the pavement.
15	• Ideal for daily grime and cleaning tasks on fence and patio.
25	• Ideal for extensive cleaning tasks.
40	• Ideal for tackling tough grime and cleaning tasks. • Remove stubborn dirt, mud, and grime from various surfaces.

5. Press and hold the safety lock (1). Pull the trigger (3) simultaneously until a constant jet of water is released from the five-in-one nozzle (8).
6. Release the safety lock (1).
7. Release the trigger (3) after use to stop the water jet.
8. Switch off the water supply and disconnect the suction hose (6) after use.

The golden rules for care



WARNING! ALWAYS REMOVE THE BATTERY PACK FROM THE APPLIANCE AFTER USE AND BEFORE PERFORMING ANY CLEANING OR MAINTENANCE TASKS.

- Keep the appliance clean. Remove debris after each use and before storage.
- Regular and proper cleaning helps ensure safe operation and prolongs the life of the appliance.
- Inspect the appliance before each use for worn and damaged parts. Do not operate it if you find broken and worn parts.



WARNING! ONLY PERFORM REPAIRS AND MAINTENANCE WORK ACCORDING TO THESE INSTRUCTIONS! ALL FURTHER WORKS MUST BE PERFORMED BY A QUALIFIED SPECIALIST!

General cleaning



NOTE: Do not use chemical, alkaline, abrasive or other aggressive detergents or disinfectants to clean this appliance as they might be harmful to its surfaces.

- Pull the trigger (3) to release the remaining pressure.
- Clean the appliance with a dry cloth.
- Drain the suction hose (6).
- Rinse the inside of the spray wand (7) and the five-in-one nozzle (8) with clean water.
- Remove any dirt deposits from the five-in-one nozzle (8) hole.
- Check for worn or damaged parts. Replace worn parts as necessary or contact an authorised service centre for repair before using the appliance again.

01 Cleaning the filter and valve opener

1. Carefully remove the filter with valve opener (5) from the suction hose (6) (Fig. 8).
2. Rinse the filter and the valve opener (5) thoroughly under running water to remove any debris or buildup. Replace the filter (5) if heavily soiled.
3. Reinsert the filter with valve opener (5) if required.

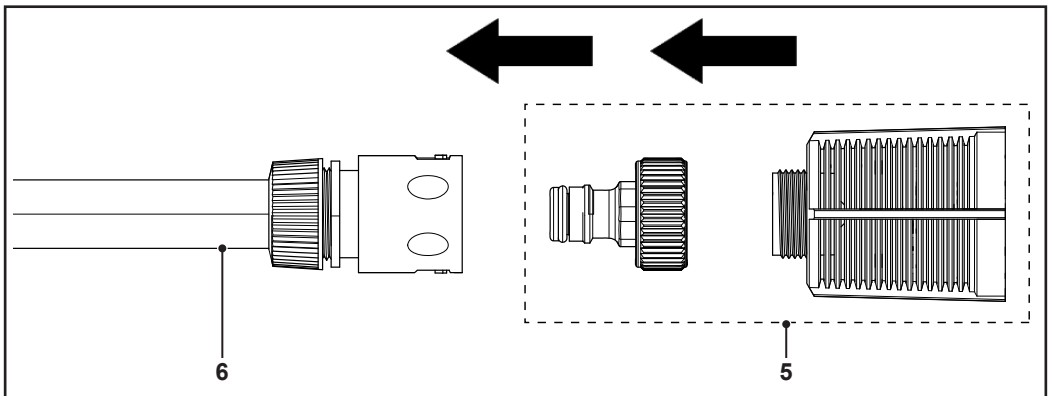

Fig. 8

Maintenance

Before and after each use, check the appliance and accessories (or attachments) for wear and damage. If required, exchange them for new ones as described in this instruction manual.

There are no user serviceable parts in the appliance.

01 Spare parts / replacement parts

The following parts of this appliance may be replaced by the consumer. Spare parts are available at an authorised dealer or through our customer service.

Description	Model no. or Specification
Battery pack	MBAT18-5 / TTI803BAT
Filter	AJP1210.1-1C
Valve opener	YLH021

Repair

This appliance does not contain any parts that can be repaired by the consumer. Contact an authorised service centre or a similarly qualified person to have it checked and repaired.

Storage

- Pull the trigger (3) to release the remaining pressure.
- Store the appliance away from corrosive materials, such as fertilizer or rock salt.
- Store the appliance in a dry, frost-free, well-ventilated place.
- Always store the appliance in a place that is inaccessible to children.
- Cover the appliance and the battery pack with a suitable cover or enclosure to protect it against dust and direct sunlight.
- The ideal storage temperature is between 10 °C and 30 °C. Store it indoors to prevent water residue in the appliance from expanding under freezing conditions.
- Store the hose on a hose hook or a reel hanger.

Troubleshooting

Suspected malfunctions are often due to causes that the users can fix themselves. Therefore check the appliance using this section. In most cases the problem can be solved quickly.



WARNING! ONLY PERFORM THE STEPS DESCRIBED WITHIN THESE INSTRUCTIONS! ALL FURTHER INSPECTION, MAINTENANCE AND REPAIR WORK MUST BE PERFORMED BY AN AUTHORISED SERVICE CENTRE OR A SIMILARLY QUALIFIED SPECIALIST IF YOU CANNOT SOLVE THE PROBLEM YOURSELF!

Problem	Possible cause	Solution
1. Appliance does not start.	1.1. Battery is too low or empty.	1.1. Charge the battery until the battery indicator lights up green.
	1.3. Battery is damaged.	1.3. Check by a specialist electrician.
2. Fluctuating pressure.	2.1. Filter is dirty, worn, or stuck.	2.1. Clean or replace the filter to ensure proper function.
	2.2. System is not reaching the required pressure.	2.2. Check for leaks in hose connection.
3. Appliance is pulsating.	3.1. Air trapped in the hose.	3.1. Press the trigger until stable working pressure resumes.
	3.2. Insufficient water supply.	3.2. Check the water supply.
	3.3. Five-in-one nozzle partially blocked.	3.3. Clear clogs from the five-in-one nozzle using a pin.
	3.4. Filter is dirty or worn.	3.4. Clean or replace the filter.
4. Appliance starts, but no water comes out.	4.1. Insufficient water supply.	4.1. Check the water supply.
	4.2. Nozzle partially blocked.	4.2. Clear clogs from the five-in-one nozzle using a pin.
	4.3. Filter is dirty or worn.	4.3. Clean or replace the filter.

Recycling and disposal



This symbol is known as the 'Crossed-out Wheelie Bin Symbol'. When this symbol is marked on a product or battery, it means that it should not be disposed of with your general household waste. Some chemicals contained within electrical/electronic products or batteries can be harmful to health and the environment. Only dispose of electrical/ electronic/battery items in separate collection schemes, which cater for the recovery and recycling of materials contained within. Your co-operation is vital to ensure the success of these schemes and for the protection of the environment.

Disposal of an exhausted battery pack



The battery is Li-Ion type. To preserve natural resources, please recycle or dispose of the battery pack properly. Consult your local waste authority for information regarding available recycling and / or disposal options.

Discharge your battery pack by operating your appliance, then remove the battery pack from the appliance and cover the battery pack connections with heavy duty adhesive tape to prevent short circuit and energy discharge.

Do not attempt to open or remove any of the components.

Customer care and technical helpline

A better way to repair your tools

Kingfisher takes special care in creating high-quality garden power tools that are designed to last. But if a fault develops with your garden power tool and you need to claim under the guarantee, the Customer Care and Technical Helpline can support with technical assistance or if required, arrange a free courier collection from your home, assess your garden power tool for fault, repair it, and return it.

Deciding to repair your product rather than buying a replacement and adding to the mountain of waste is a more sustainable choice and you will be doing your bit for the environment.

How does it work?



Get in touch

If you need help or more information, please contact the Customer Care and Technical Helpline:

UK 0330 678 3077

ROI 1 800 365 800

Opening hours are Monday – Friday, 8 am - 5 pm

Availability of spare parts

Contact the customer service helpline for assistance or visit www.kingfisherspares.com

For assistance contact the customer services helpline:

UK 0330 678 3077 uk@kingfisherservice.com

ROI 1 800 365 800 eire@kingfisherservice.com

Further information about this product can also be found at:

www.kingfisher.com/products



EN Guarantee

We take special care to select high quality materials and use manufacturing techniques that allow us to create products incorporating design and durability. This product has a manufacturer's guarantee of 2 years against manufacturing defects, from the date of purchase (if bought in store) or date of delivery (if bought online), at no additional cost for normal (non-professional or commercial) household use.

To make a claim under this guarantee, you must present your proof of purchase (such as a sales receipt, purchase invoice or other evidence admissible under applicable law), please keep your proof of purchase in a safe place. For this guarantee to apply, the product you purchased must be new, it will not apply to second hand or display products. Unless stated otherwise by applicable law, any replacement product issued under this guarantee will only be guaranteed until expiry of the original period guarantee period.

This guarantee covers product failures and malfunctions provided the product was used for the purpose for which it is intended and subject to installation, cleaning, care and maintenance in accordance with the information contained in these terms and conditions, in the user manual and standard practice, provided that standard practice does not conflict with the user manual.

This guarantee does not cover defects and damage caused by normal wear and tear or damage that could be the result of improper use, faulty installation or assembly, neglect, accident, misuse, or modification of the product. Unless stated otherwise by applicable law, this guarantee will not cover, in any case, ancillary costs (shipping, movement, costs of uninstalling and reinstalling, labour etc), or direct and indirect damage.

- This guarantee does not cover defects and damage caused by or resulting from:
- Normal wear and tear
- Overload, misuse or neglect
- Repairs attempted by anyone other than an authorised agent
- Cosmetic damage
- Damage caused by foreign objects, substances or accidents
- Accidental damage or modification
- Failure to follow manufacturer's guidelines
- Loss of use of the goods

If the product is defective, we will, within a reasonable time, repair or replace it.

Rights under this guarantee are enforceable in the country in which you purchased this product. Guarantee related queries should be addressed to the store you purchased this product from.

The guarantee is in addition to and does not affect your statutory rights.

**IMPORTANT - RETAIN THIS INFORMATION
FOR FUTURE REFERENCE:
READ CAREFULLY**

Manufacturer:

UK Manufacturer:

Kingfisher International Products Limited,
1 Paddington Square, London, W2 1GG,
United Kingdom

EU Manufacturer:

Kingfisher International Products B.V.,
Rapenburgerstraat 175E,
1011 VM Amsterdam,
The Netherlands

EN www.diy.com

www.screwfix.com

www.screwfix.ie

**To view instruction manuals online,
visit www.kingfisher.com/products**